

ST. DOMINIC CATHOLIC PARISH

“You are the faithful people of St. Dominic, and upon you I will build my church.”

CAMPAIGN GOALS

The Faith in Our Future Campaign provides Jesus with the opportunity to build His Church upon our faith and sacrificial giving in the following important ways:

- Strengthen Archdiocesan initiatives in the areas of Catholic schools, religious education programs, adult faith formation programs, lay leader training, seminary training, marriage and family programs, and Catholic campus ministry,
- support Catholic education and faith formation initiatives around the world, especially in mission areas,
- *and build community through three capital improvement projects at St. Dominic Catholic Parish.*

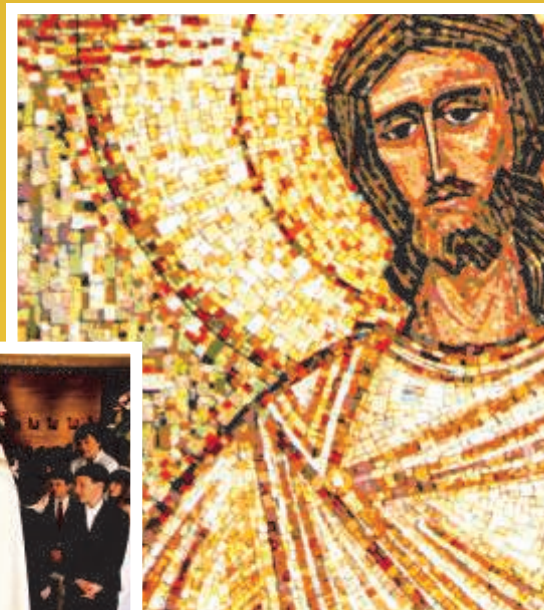

FAITH
IN OUR FUTURE

INTERIOR CHURCH RENOVATION

\$800,000

FAITH
IN OUR FUTURE

It all started with that singular moment of Grace when Jesus uttered those famous words: “You are Peter, and upon this rock I will build my church.” From that moment on, Jesus has been building the Church upon the rock-solid foundation of faithful believers.

We know this to be true through our own grace-filled history. In 1956, Jesus established our own church of St. Dominic on the firm foundation of our faithful charter members. Continuing that work over the past 52 plus years, Jesus has been building the community of St. Dominic with a clear mission:

“To Seek Christ, Know Christ, and Become Christ, Each One for the Sake of All.”

In 2008, we are once again at a moment of Grace. We now have the privilege and opportunity to be the faithful believers upon whom Jesus builds his church.

The St. Dominic goals for the Faith in Our Future Campaign have been determined through a process of thorough study. Based on our Vision 2012 Strategic Plan and the subsequent Master Plan for Capital Improvements, we have identified three specific projects. This is the inspiring and hope-filled vision that we can realize through your generous support of our campaign.

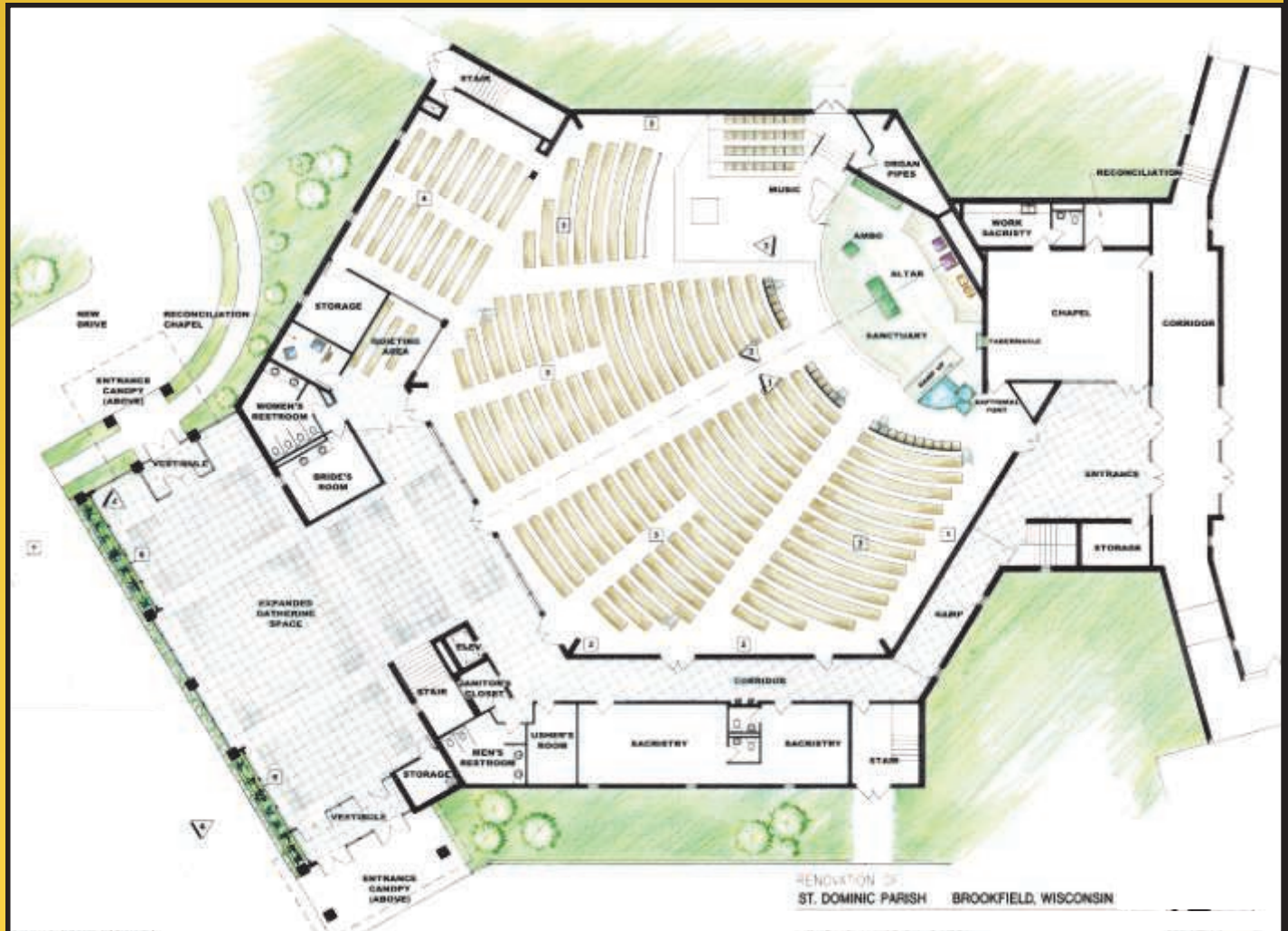

Enhanced Baptismal Font and Tabernacle

Envision our precious babies and new adult Catholics being reborn in the living waters of a newly designed baptismal font. Incorporating the existing font, the new design will highlight the importance of the Sacrament of Baptism through the following features: a larger and more prominent font, running water that cascades from one level to the next, a lower pool large enough to accommodate adult initiation at the Easter Vigil, and proximity allowing people to sign themselves as they gather for worship.

Witness the faithful community genuflecting before the Lord's Real Presence abiding in an enhanced tabernacle. The proper importance of the tabernacle will be accentuated by framing the existing tabernacle in an elegant gold leaf.

"These projects are cornerstones for our future as a welcoming community, a place to gather, a destination for faith and fellowship."

Gerri Schultz, parishioner



Expanded seating-quieting area

Dream of a growing church where all are welcome due to the expanded seating capacity created by new radial pews and an additional seating area. The existing pews will be replaced with radial (curved) pews which are more efficient. The interior south wall of the nave, reconciliation room and cry room walls are to be removed and supported with new columns to give maximum view. The radial pew design and new additional seating area provide a 25% increase over the existing layout, approximately 1000 seats. Stone being removed will be reused for the future expansion of the south narthex.

A new reconciliation room, quieting area, and storage room are to be built in this area.



Interior Enhancements

Imagine our community gathering for worship in a nave with new complementary hues and new flooring. Existing carpet will be replaced with 12" x 12" porcelain tiles.

Listen to the congregation pray and sing enthusiastically as a result of upgrades to the sound and lighting systems, including improving all light levels, a new main sound system, suspended choir microphones, radio frequency system to aid the hearing impaired, and sound connection to Marcy Center.

Hear God's Word resound from the ambo which is unobstructed and in a rightful place of prominence. The choir ramp and railing will be removed as a new ramp will be created near the baptismal font. Acolytes will be seated near the presider and deacon. Wall statues and art will be relocated and lowered to create private prayer areas in the church. The stations of the cross will all be located on the north wall and receive an accent background.



Our HOPES, Our DREAMS, Our VISION

NEW ATHLETIC FACILITY

\$3,100,000

Imagine St. Dominic Catholic Parish not just as an occasional spiritual stop-off, but as the central locus of our lives.

Dream of a place where people of all ages can build strong and lasting relationships within a community that prays and plays together.

Envision our children and youth enthusiastically seeking St. Dominic as their desired destination for a variety of athletic and recreational opportunities currently not possible within our existing gym space.

Our HOPES, Our DREAMS, Our VISION

- All our elementary school teams could practice on the St. Dominic campus.
- We can offer programs for our youth and young adults keeping them close to St. Dominic.
- We can offer programs for our younger children helping to build the St. Dominic community.
- We can develop programs for our seniors.
- We can expand programs for our adults.



Vision: We believe a new athletic facility will strengthen the St. Dominic community.

The current gym is well above usage capacity. Over 400 student athletes use our gym. Our 17 volleyball teams are the most for any parish in the archdiocese. Teams are currently renting practice space at other facilities with expenses costing over \$16,000 per year. Due to our limitations of available facilities, children take advantage of programs offered at other area churches.

The facility would hold one main court, 84' x 50' but also allow for two full-size courts that could be used concurrently making tournaments a possibility as well as allowing practices at more appropriate times. Adult and youth can participate in recreational activities side by side fostering a sense of community and bridging relationships between age groups. This facility will include new locker rooms.

A new concession stand and lobby will increase fan comfort and generate additional revenue. New restrooms with potential outside access will be an added benefit for many parish events held on our grounds.

A new facility will make our parish more attractive to families interested in our day school and lifelong faith formation programs.

Total Square feet: 11,000.
Bleacher seating: 200 Fans!

Dreams

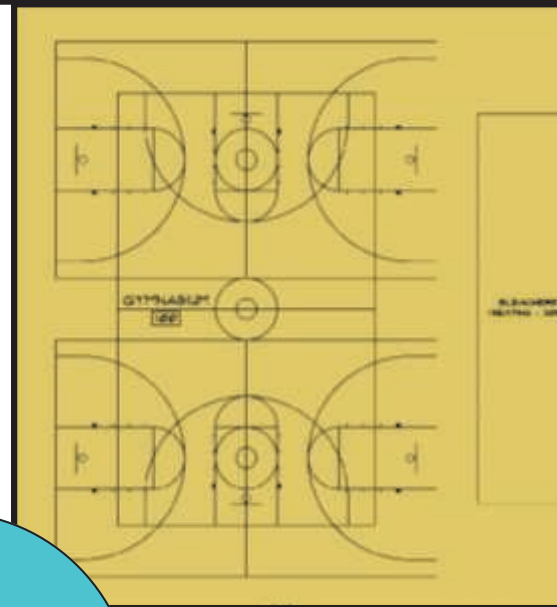

FAITH
IN OUR FUTURE



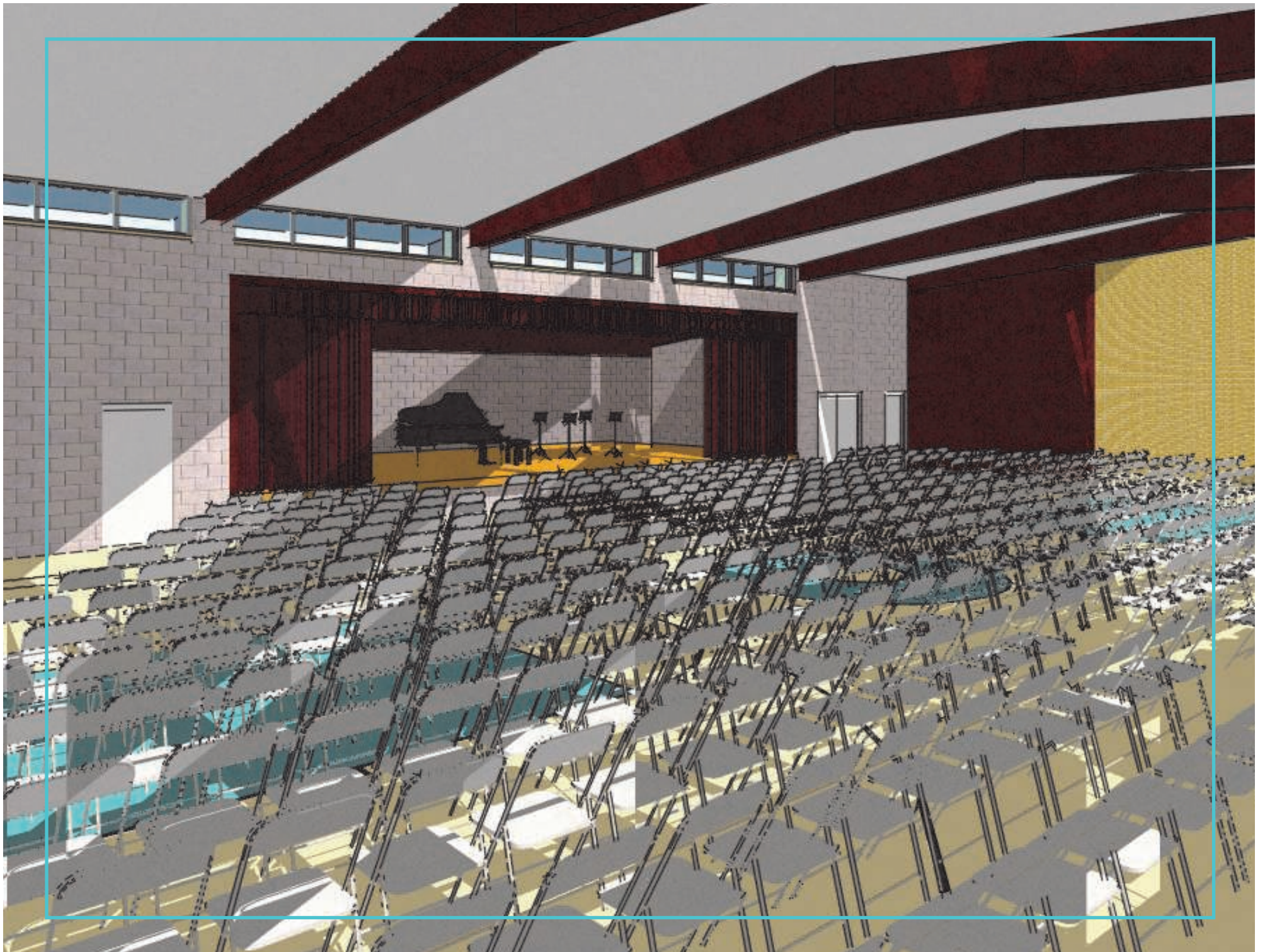

PARISH ARTS & ACTIVITIES CENTER

\$400,000

FAITH
IN OUR FUTURE

Our Dream is to transform the existing gym into a parish arts and activity center. At a time when programs in the fine arts are being cut back or eliminated altogether, *imagine* a community coming together around thriving programs of drama, music, and the visual arts. Join large parish groups of all ages gathering for an inspiring Christian movie, speaker, or musical performer. *Envision St. Dominic Parish as a community built around a beehive of arts and activities.*



Currently, most plays and other performances are held in the Marcy Center, which has limited seating capacity. The only place that can hold our entire day school is the church. The fine arts program continues to grow at St. Dominic. For many, these skills are a lifelong journey. Theater programs are offered for students in grades 7 and 8.

A summer theater camp is offered for grades 1-8. Musical performance, band, strings and youth choir are offered for grades K4-6. Most rehearsal sessions are currently in the Marcy Center, but due to space constraints, some St. Dominic musicians travel to St. John Vianney for weekly rehearsals. Band concerts are currently performed at St. John Vianney Parish. Renovating the existing gym will include:

- Stage area for performances which will allow better sight lines
- Seating for approximately 500
- Appropriate lighting and sound systems

A dedicated arts and activities center could attract well-known speakers and groups, allowing priority scheduling for these large events. It will allow for multiple day events and advance set up. The existing floor would remain allowing for this space to still function as an auxiliary gym.



“Our family has always felt a strong sense of community at St. Dominic. Whenever we have needed help, we have had more people to help than necessary. We view the Faith In Our Future campaign as the next evolution of the St. Dominic faith community. While the campaign will allow us to build and enhance our physical structure, it is much more about the people who fill the buildings. It is about keeping our high school and college students involved. It is about gatherings after church to connect with each other. It is about having pride in our campus. It is about drawing the next generation of Catholics into our community.” Don Drees, parishioner

Our Hopes. Our Dreams. Our vision

Each of the facility enhancements presented on these pages will provide the needed resources where parishioners can share the spiritual, educational, recreational, cultural, and social events of their lives in a way that will build lifelong connections and community at St. Dominic.

This is our time to stand in Peter's shoes. This is the grace-filled moment when Jesus says to us, "You are the faithful people of St. Dominic, and upon you I will build my church!" We can provide the solid foundation for this building to happen through our enthusiastic support of the Faith in Our Future Campaign.

Empowered by prayer and committed to shared sacrifice, we can achieve our campaign goals. Having faith in our future, we trust that Jesus is building the church of St. Dominic into a community that seeks, knows, and becomes Christ, each one for the sake of all.

BEYOND THE CAMPAIGN CASE as future funds allow

Expanded gathering space \$525,000

Additional gathering space is to be created at the existing south entrance. The current canopy is to be utilized as part of the new space. The gathering space will feature 2 new side entrances and a car canopy.

The south windows of the new gathering space will incorporate the stained glass currently located between the nave and the south narthex. As a replacement, clear sliding windows will be installed in order to provide a view into the nave, especially for overflow seating.

Expanded gathering space could accommodate approximately 300 people before and after Mass for social or ministry purposes. The new area would accommodate 21 five foot diameter tables that would seat 126 people when desired.

A new drive-up area will be created between the parish center parking lot and main south drive for access to gathering space.



School expansion and Marcy Center Upgrade \$925,000

School: A 5200 square foot, two story expansion would allow the two first grade classes to move to the upper level and allow further growth in the pre-school and after-school area. Lower level space could provide for a variety of uses including school offices, conference rooms, classrooms, etc.

Marcy Center: Upgrades would include a lower maintenance floor option to enhance appearance, development of a permanent nursery, and updating the kitchen to allow for preparation and warming of food.

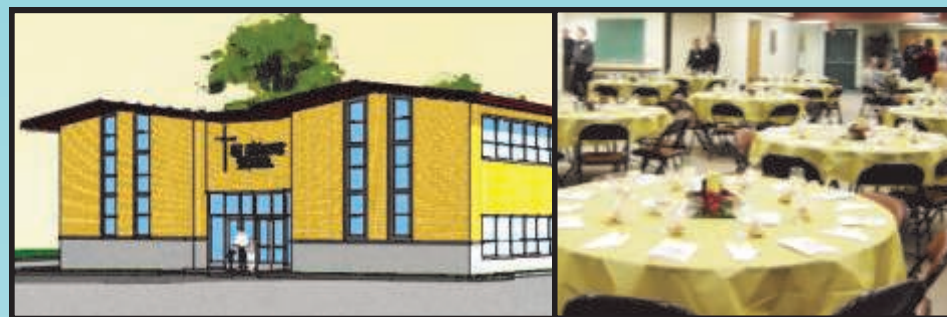

Our Hopes, Our Dreams, Our Vision